

# Use and maintenance - SC401 (cord)

ATTENTION! Do not use the machine before you have read and understood the Instructions for use manual



1. Fill the tank with clean water and dosage a suitable detergent according to the specifications. The water temperature must not exceed 40 °C.



2. Make sure the solution valve under the machine is open.



3. Install the squeegee and fasten it with the knob. Lower the squeegee with the pedal.



4. Place the brush or the pad-holder under the deck. Use the appropriate brush to clean the floor. Lower the deck by pressing the pedal deck.



5. Connect the power supply plug to the electrical mains.



6. Turn the main switch to "I", press the main button (LED on) to start the machine.



7. For sensitive floors the brush/pad can be pre wetted with solution before starting to work to avoid marks. Press the main button and the solution button simultaneously for 10/20 seconds before starting to work.



8. Start cleaning by placing the hands on the touch sensors on the handlebar.



9. Press the solution button to adjust the solution flow to the cleaning needs. When the LEDs are off, the solution flow is off



10. Press the main button (LED off) to stop the machine, turn the main switch to "0". Disconnect the power supply plug from the electrical mains



11. Place the power supply cable on his holder.



12. Lift the brush deck by pressing the pedal, remove and clean the brush/pad.

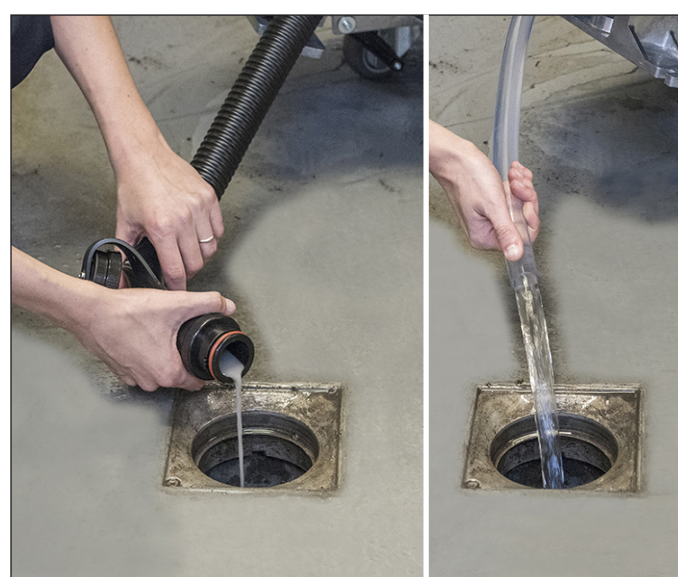

13. Empty the recovery tank with the hose. Then empty the solution tank with the transparent hose.



14. Empty the debris tray and clean/wash the recovery tank inside.

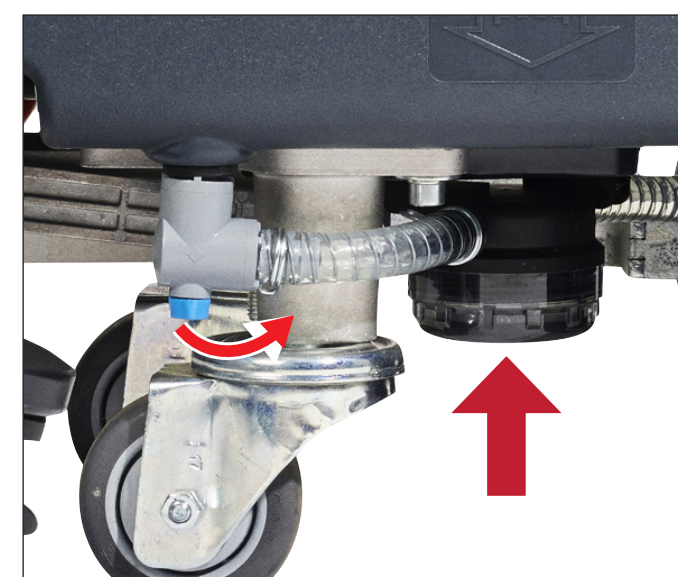

15. Clean the filter:  
A) Close the solution valve under the machine.  
B) Remove the transparent cover and the gasket, then remove and clean the filter inside.  
C) Reassemble the filter.



16. Take the squeegee off and remove debris. Check and clean the squeegee blades.



17. Clean the machine using a damp cloth and where needed use a neutral cleaning product.



18. Park the machine with the recovery tank cover open.

# Troubleshooting

## - SC401 (cord)

ATTENTION! Do not use the machine before you have read and understood the Instructions for use manual

The machine doesn't work as it should?



1. Check the power supply cable to see if it is damaged, faulty or disconnected from the electrical mains. (\*)



2. Check if the main switch is faulty. (\*)

(\*) For these causes the maintenance procedure must be performed by an authorised Nilfisk Service Center.

For further information refer to the Service Manual, available at any Nilfisk Service Center.

The suction doesn't work as it should?



1. Check if the suction hose is correctly installed and cleaned.



2. Open the recovery tank and check the debris tray and float are clean and working.



3. Check if squeegee blades are damaged or dirty.



4. Check the lid gasket is in good and working condition and sealing when lid is closed.

The machine doesn't clean as it should?



1. Check if you have the right detergent and water settings.

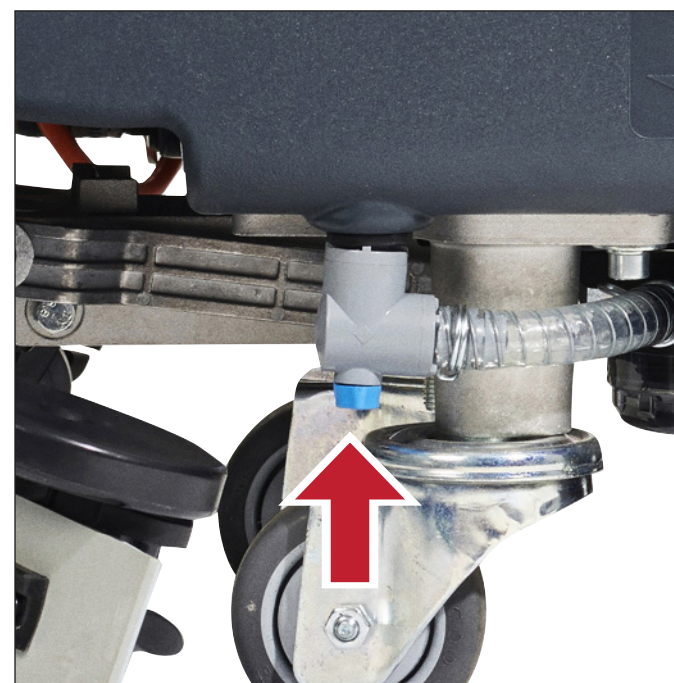

2. Check if the solution valve is open.

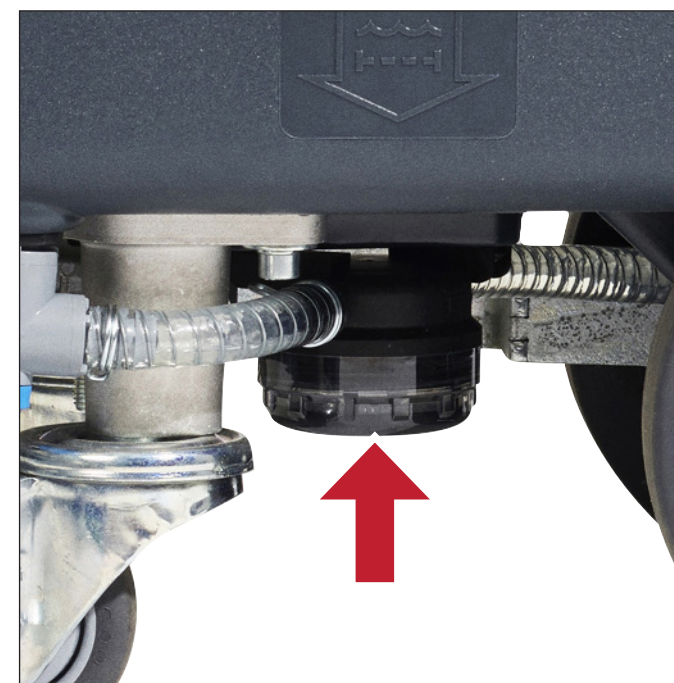

3. Check if the solution filter is cleaned.

The brush doesn't work as it should?



1. To adjust machine direction turn front knob until machine is working straight.



2. Check if the brush are correctly installed and not worn out or if there are external materials avoiding brush rotating.